

# BIN VENT FILTER

## SQUARE/RECTANGULAR



### CONTROL DUST. RECOVER PRODUCT. MANAGE EMISSIONS.

The square/rectangular bin vent filter from Carmeuse Systems is designed to vent displaced air from storage silos or bins during filling by a pneumatic or mechanical convey system. While venting displaced air, it prevents dust particles and other harmful products from being emitted into the atmosphere or surrounding environment. This bin vent uses four to nine polyester or PTFE laminated spunbonded cartridges to remove dust from the air. The filter media captures dust particulates in the displaced air while discharging cleaned air to the environment. A set of reverse pulse jets activate sequentially to clean material off the filters and blow the collected dust particulates back into the storage silo or bin. This bin vent is compact in design, easy to install, eliminates ductwork and reduces your installation expense.

### APPLICATIONS & USE

#### Typical Bulk

#### Materials Processed

- Lime
- Soda Ash
- Powder Activated Carbon (PAC)
- Trona
- Fly Ash
- Cement
- Sugar
- Others

#### Typical Applications

- Moist Agglomerative Dust Applications
- Water Treatment
- Food
- Chemical Processing
- Mining
- Grain Handling
- General Industrial
- Oil and Gas
- Glass and Ceramics
- Pulp and Paper
- Pharmaceutical
- Powder Coating

Applicability can vary by system make and model. For an evaluation, contact us: [salesinquiries@carmeuse.com](mailto:salesinquiries@carmeuse.com)

### FEATURES

### BENEFITS

Compact, low-profile, top access body design

Eliminates the need for ladders, cages or platforms improving employee safety

Welded housing shipped ready to install

Mounts quickly and offers a durable design providing structural stability

High efficiency cartridge filter media

Removes over 99.99% of entrained particles across applications increasing efficiencies

Sequential timer option mounted in a NEMA 4, 4x, 7, 9 or 12 enclosure

Operates as standalone unit in either indoor/ outdoor locations providing flexibility

Lightweight, tool-less, hinged top access door

Provides clean air side access to filters and requires no tools during cartridge replacement reducing maintenance costs

Continuous-duty, on demand sequential pulse cleaning

Provides uninterrupted services and cleans filters reducing maintenance needs

Exhaust blower fan option

Draws air out of the silo to outdoor site improving venting performance

Low energy requirements

Minimizes air usage through cleaning frequency calibration improving efficiencies

Flanged bottom housing design

Makes securing on silos or bins easy and reliable improving safety

Canadian Registration Number (CRN) registered air header

Meets or exceeds Canadian government air quality regulations for optimal plant safety

## SPECIFICATIONS

### MATERIAL OF CONSTRUCTION

- **Standard:**
  - Body: A36 Carbon Steel
  - Air Manifold: A53 Carbon Steel
  - Pulse Jet: Aluminum
  - Pulse Jet Seal: Nitrile
  - Filter Media: Spunbonded 100% Polyester Cartridge
- **Options:**
  - Body: 304 Stainless Steel
  - Air Manifold: 304 Stainless Steel
  - Pulse Jet Seal: Viton
  - Filter Media: PTFE Laminated Spunbonded 100% Polyester Cartridge

### PROCESS REQUIREMENT

- **Air Supply:** Dry and oil-free compressed air 6 to 10 SCFM [10 to 17 m<sup>3</sup>/h] @ 80 to 120 psig [552 to 827 kPag]

### INSTRUMENTATION AND CONTROLS

- **(Optional) Differential Pressure Transmitter:** 4-20 mA HART
- **Discrete Control and Alarm:** 24 VDC / 120 VAC
- **Local Panel / Junction Box Rating:** NEMA 4, 4X, 7, 9 or 12 [IP66 or 52], electrical enclosures on all collectors
- **Approvals:** CSA, FM, cULus, CE Marking

MODEL	A (in. [mm])	B (in. [mm])	C (in. [mm])	D (in. [mm])	E (in. [mm])	F (in. [mm])
DCC-280	36 [915]	36 [915]	46 [1169]	35 [889]	21 1/2 [547]	47 [1194]
DCC-420	54 [1372]	36 [915]	64 [1626]	35 [889]	23 1/2 [597]	65 1/2 [1664]
DCC-630	54 [1372]	54 [1372]	63 [1601]	35 [889]	28 [712]	60 1/2 [1537]

PLAN VIEW

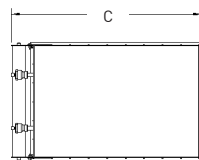

SIDE VIEW

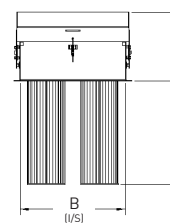

ELEVATION VIEW

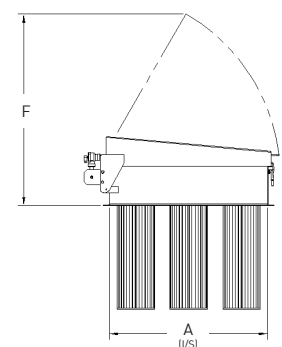

## YOUR LIME HANDLING EXPERTS™

Carmeuse Systems is your trusted partner for designing, integrating, and upgrading lime handling systems. As part of the Carmeuse Group, our teams have unrivaled expertise in understanding the role of lime handling equipment within your operation. From selecting the appropriate raw material, to system engineering, enhancements, and maintenance, our teams provide End-2-End support and guidance. We make complex projects seem simple and help our customers every step of the way. Let's start a conversation, contact us at:

[salesinquiries@carmeuse.com](mailto:salesinquiries@carmeuse.com)

+1-905-875-5587

[systems.carmeuse.com](http://systems.carmeuse.com)

CANADIAN HEAD OFFICE:  
8485 PARKHILL DRIVE  
MILTON, ON L9T 5E9, CANADA

US HEAD OFFICE:  
3600 NEVILLE ROAD  
PITTSBURGH, PA 15225

The information contained in this product data sheet is, to the best of our knowledge, true and accurate. As application-specific factors may impact performance, users are advised to evaluate the product independently to determine suitability for the intended application and use conditions. Product availability and specifications are subject to change without notice.

Carmeuse and the Carmeuse logo are registered trademarks of Carmeuse Lime, Inc. © 2024 Carmeuse Systems. All rights reserved. v. 24.03.04